

# Floor guide ALUDECK SYSTEM P-5

## Installation manual

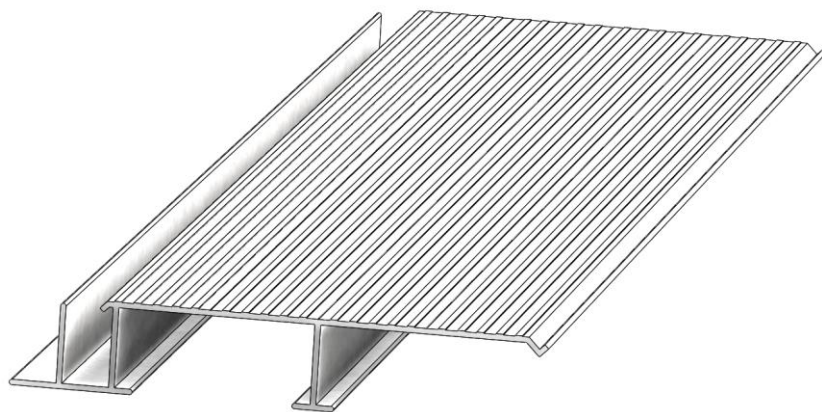

**ALUDECK System  
P-5 Open profile**

## Dimensions of ALUDECK System P-5 Floor / M5 Moulding

Usable width  
12,5 cm (+/- 4 3/4 po)

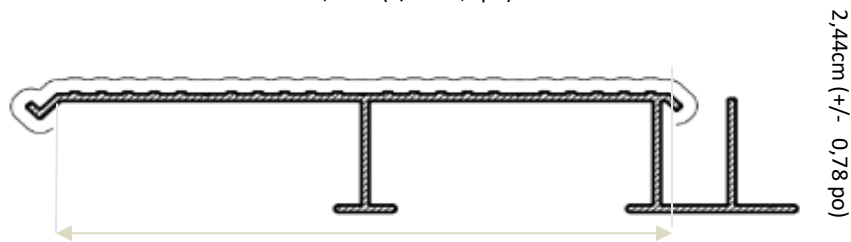

3,1 cm (+/- 1,18 po)

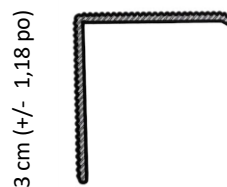

# Aluminium floor system

## ALUDECK System P-5

Each ALUDECK System P-5 aluminum plank has its own drainage system, to remove water in the event of rain or melting snow.

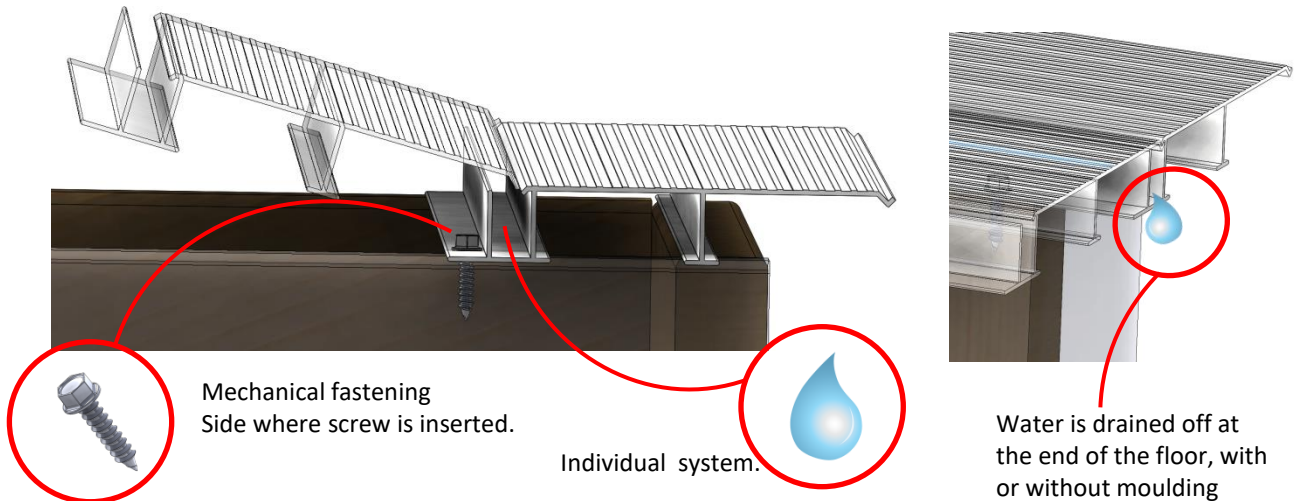

ALUDECK System P-5 aluminium decking can be installed directly on all types of structures without the need to install an additional erosion barrier.

Different screws to be used :



Aludeck System P-5  
installed on a wooden  
Structure  
Example :SCREW # 5/30

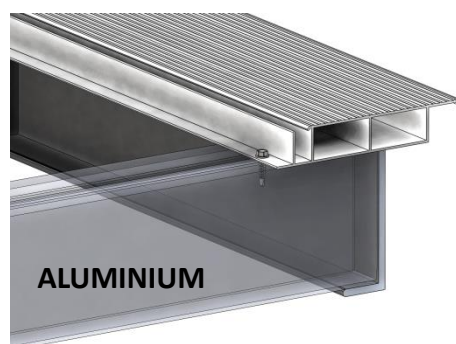

Aludeck System P-5  
installed on an aluminium  
structure  
SCREW # 6/30 self-drilling



Aludeck System P-5  
installed on a steel  
structure  
SCREW # 6/30 self-drilling

# Preparatory Guide for Aluminium Floors

## ALUDECK System P-5



**STRUCTURE: Maximum centre-to-centre distance.**

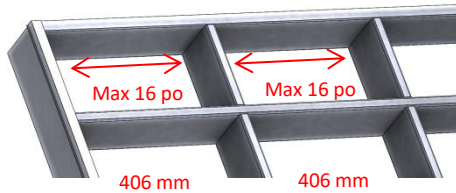

**SLOPE: 1/8 po per foot (minimum recommended)**

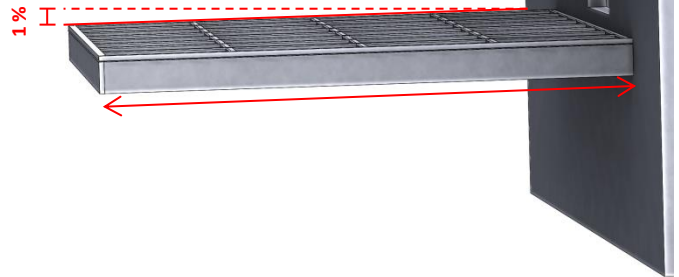

**Example of structure coast :**  
(120 po X 144 po)

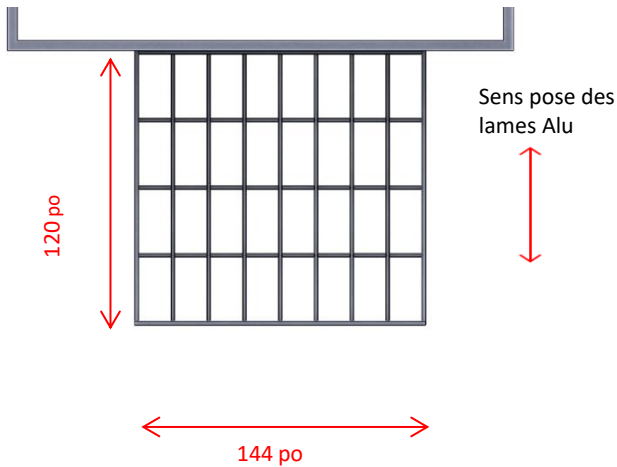

**Example PLANCHER ALUDECK System**  
(121 po X 146 po)

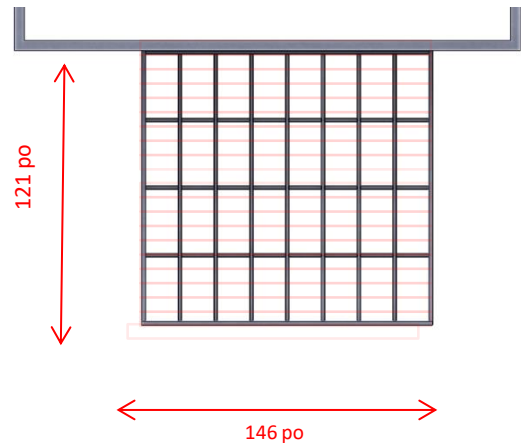

### ALUDECK SYTEM P-5

**P5 Do-it-yourself start by edging a blade**

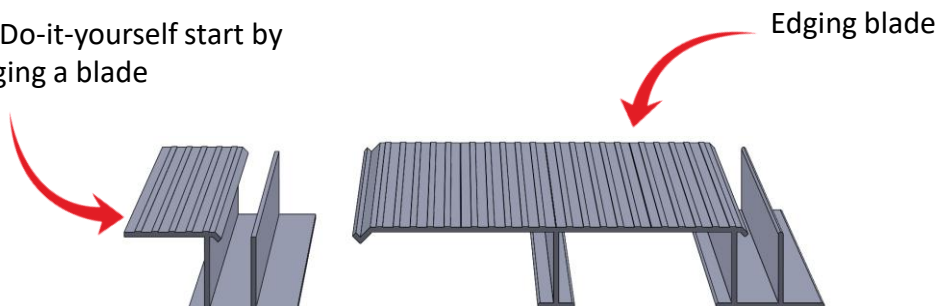

Optional ways of installing ALUDECK SYSTEM flooring depending on the width of the structure

**P5 Depart**

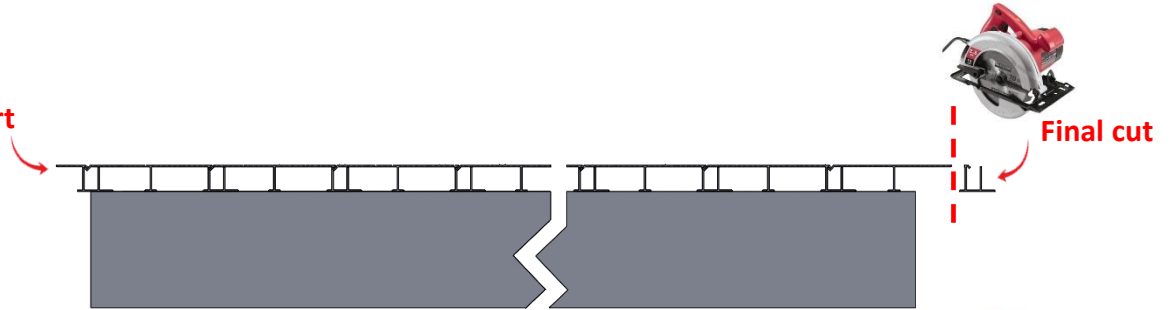

**P5 board**

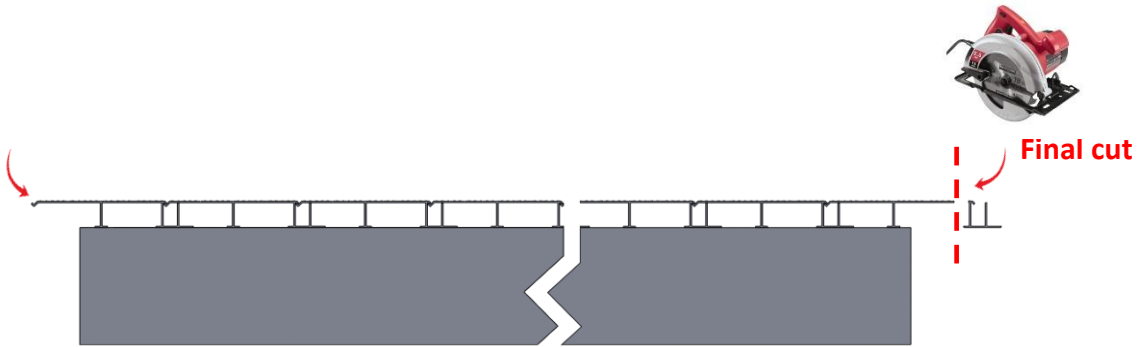

**P5 board**

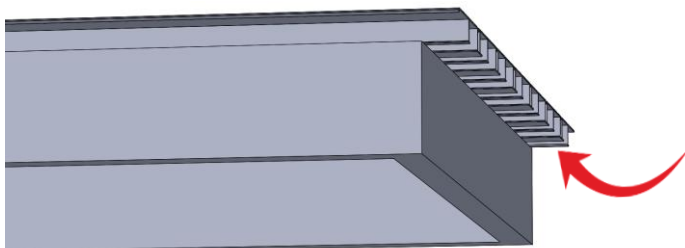
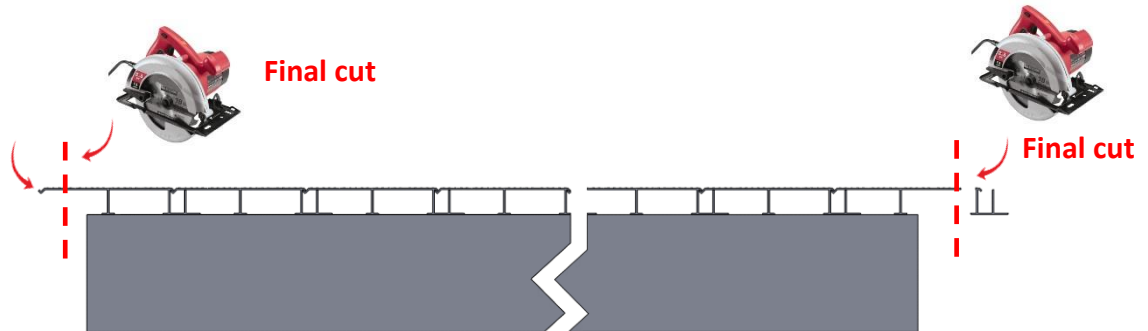

**NOTE: You need a minimum of 1 po front overhang for adequate water drainage.**

Start with an Aludeck System P-5 Start board  
 Or Aludeck System P-5 overhanging the side of the structure by 1 po..

D  
E  
P  
A  
R  
T

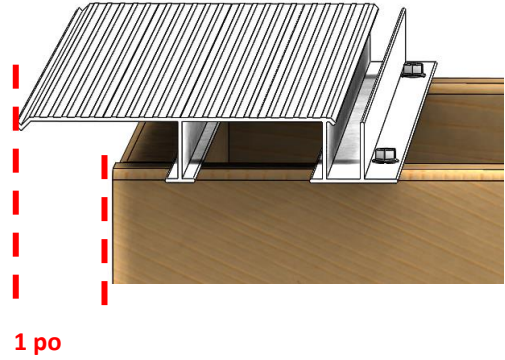
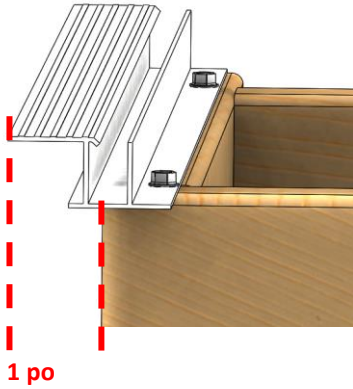

The next board is an ALUDECK System P-5 You will need to apply pressure to ensure that your installation is tight and gap-free.

Screw the ALUDECK System board into the structure using the fixing strip which runs along the gutter of the board..

F  
A  
S  
T  
E  
N  
I  
N  
G

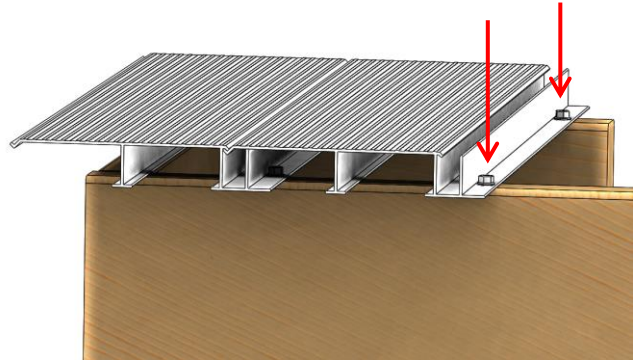
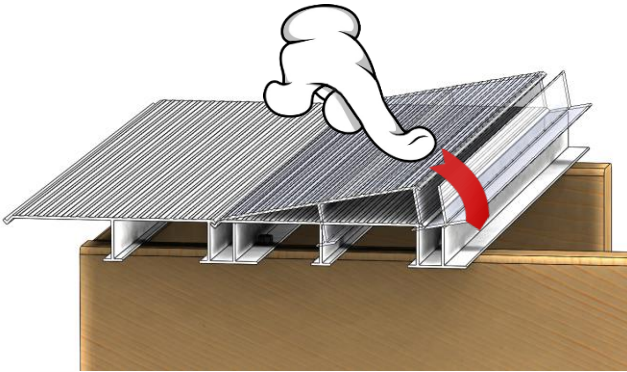

The last plank,  
 Cut the gutter and extend  
 1 po outside the structure.

**TIP:** For overhead balconies, seal the inside of the gutter of each each board installed against the wall

E  
N  
D

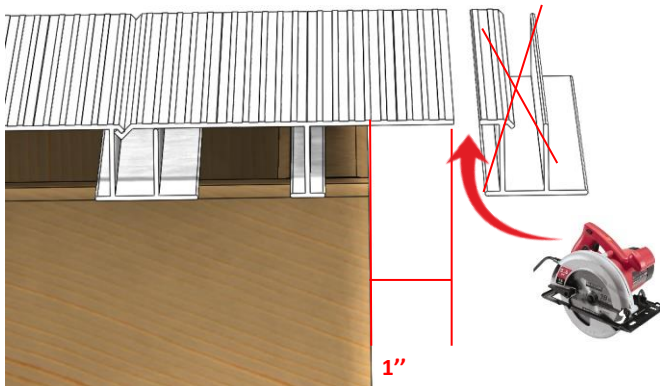

Once the Aludeck System floor has been installed, cut the end of the floor to the desired length.

Example

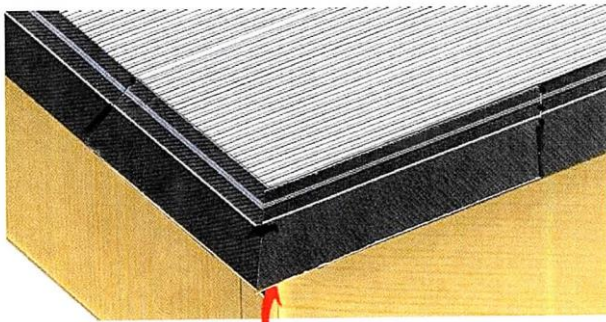
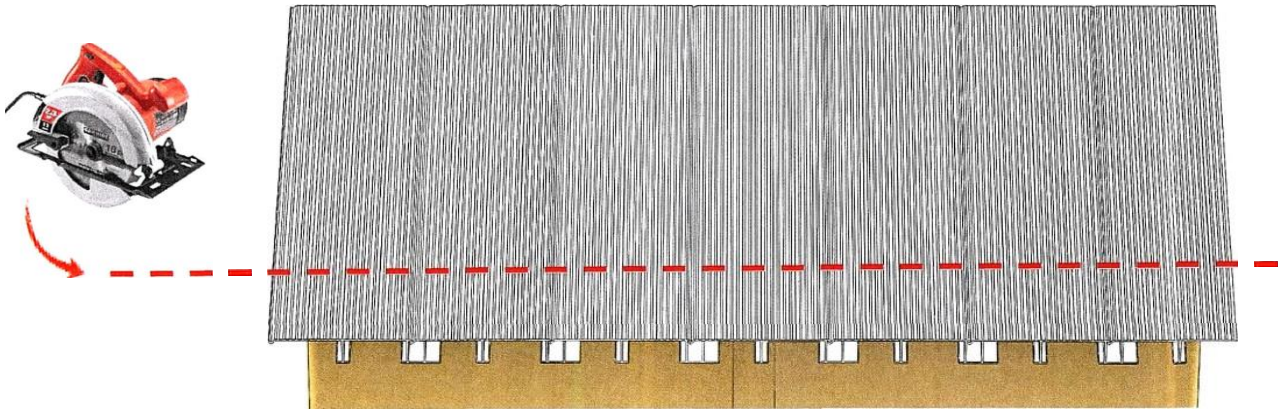

Installing mouldings with a mitre cut.

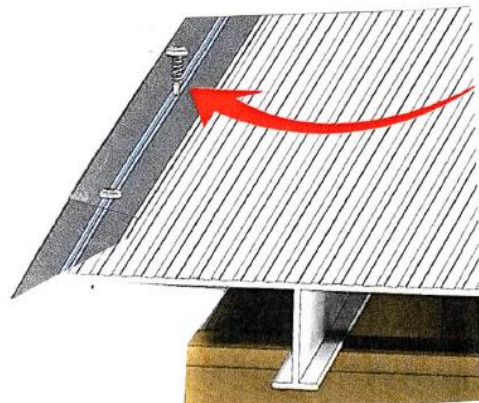

Use a self-drilling screw #4/15



To be cut with a special aluminium blade

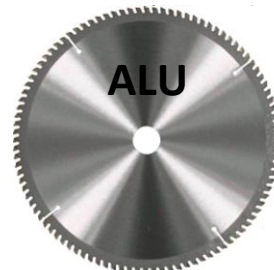

**Finishing moulding  
M-5**

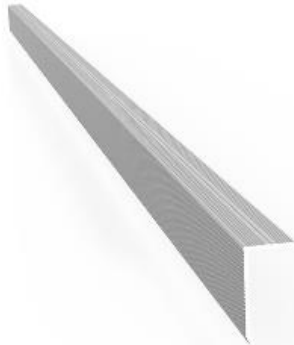

**Aludeck System board  
P5**

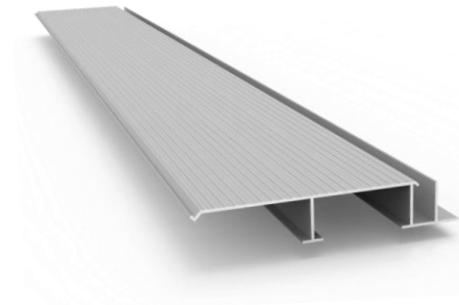

**Examples of screws and bolts (not supplied)**



**# 4/15 Self-drilling screw for finishing moulding.**

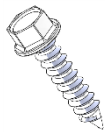

**# 6/30 Screw with tip for ALUDECK System P-5 on wooden structure.**



**# 6/30 Self-drilling screw for ALUDECK System P-5 on aluminium structure**

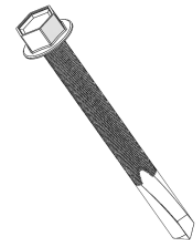

**# 6/30 Self-drilling screw for P-5 on steel structure**